

Blue Sky Network

ASE RESILIENCE SOLUTION

Permanent-Satphone

Comcenter Indoor-MC08



SUMMARY OF KEY FEATURES

- PROVIDES OFFICE/IN-BUILDING SOLUTION FOR IRIIDIUM SATPHONE
- NON REMOVABLE
- PERFECT FOR HIGHLY TRAFFICKED AREAS
- EASY CONNECTION TO IRIIDIUM ANTENNA FOR INDOOR USE
- PROVIDES VOICE CONTINUITY IN DISASTERS--NATUAL OR MAN-MADE
- RELIABLE ASE EQUIPMENT

ASE-MC08 Iridium SatPhone Solution

Shown below are the components that are included with, or needed for the ASE-MC08.



Antenna Solutions

Antennas and cable systems for HQ applications. We recommed our premium filtered for Urban and Hospital environments.

Purchase separetely-



Power Brick AC/DC

Reliable AC/DC Power Supply. Please specify Country Type.

Included in the Kit.



Dedicated Phone

We recommend the PT01 with Dialing Instructions. (Can integrate with any office phone.)

ASE PT01



ASE-MC08		
Voltage	10-32 VDC	Cable or DC Adapter
Power	12 Watts	Active Peak
Antenna Connections	Iridium TNC-F	
Operating Temp	-10 to 55 C	
Dimensions	9x 5 x 2.5 in.	23 x 15 x 13 cm
Weight	2 lbs.	0.9 kG
Shipping Weight	6.0 lbs.	3.0 kG
Shipping Dimensions	16 x 14 x 8 in.	41 x 36 x 20 cm

IRIDIUM PERMANENT INSTALL SATELLITE PHONE

V 1.1

ADDITIONAL FEATURES/COMPONENTS



Easy Office Integration

Use with Office Phones
Can integrate with any office.
 We recommend the ASE-PT01



-H Local Handset-

Local Handset available.
Purchase by adding -H
 ASE MC08-H



Antennas go the Distance

Passive Antennas up to 20 Meters. Active Antennas up to 105M
Antennas not included-
Purchase separately.

EXAMPLE INSTALLATION

SYSTEM SETUP

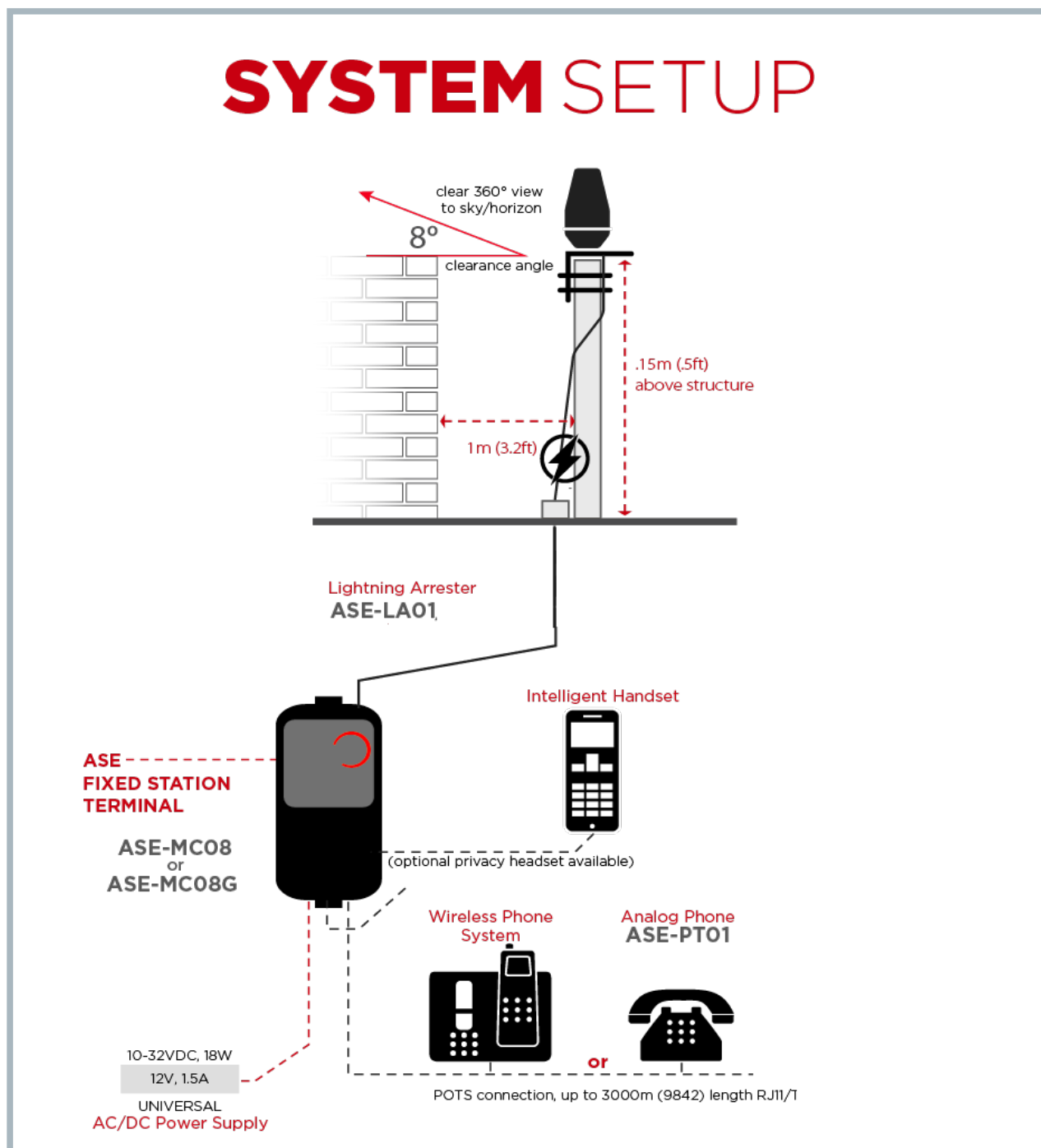

MC08 INSTALLATION DIAGRAM

MC08 PACKAGES AND COMPONENTS

SHIPPING INFORMATION

ASE-MC08

ComCenter II Indoor - fixed station iridium voice terminal

Harmonized Code - HTS#: 8517.62.0050 **ECCN:** 5A992.a

Shipping Dimensions: 16 x 14 x 8, 6 LBS (41cm x 36cm x 20cm, 3 kg)



ASE-MC08-H

ComCenter II Indoor - fixed station iridium voice terminal

Harmonized Code - HTS#: 8517.62.0050 **ECCN:** 5A992.a

Shipping Dimensions: 16 x 14 x 8, 6 LBS (41cm x 36cm x 20cm, 3 kg)



ASE-PT01

POTS Station - includes POTS phone, mount plate, and instruction placard

Harmonized Code - HTS#: 8518.30.2000 **ECCN:** EAR99

Shipping Dimensions: 16 x 14 x 8, 5 LBS (41cm x 36cm x 20cm, 2 kg)



ASE ANTENNA AND CABLE OPTIONS:



CABLE LENGTHS and ANTENNA OPTIONS:

ASE-PFA12 - 39' (12 meters) LMR600

- premium passive filtered antenna, lightning arrester, and mounting bracket

ASE-PFA20 - 66' (20meters) LMR600

- premium passive filtered antenna, lightning arrester, and mounting bracket

ASE-PFA27 - 100' (27 meters) LMR200

- premium active filtered antenna, lightning arrester, interface box, and mounting bracket

ASE-PFA40 - 131' (40 meters) RG213

- premium active filtered antenna, lightning arrester, interface box, and mounting bracket

ASE-PFA70- 230' (70 meters) LMR400

- premium active filtered antenna, lightning arrester, interface box, and mounting bracket

ASE-PFA88 - 289' (88 meters) LMR500

- premium active filtered antenna, lightning arrester, interface box, and mounting bracket

ASE-PFA105 - 344' (105 meters) LMR600

- premium active filtered antenna, lightning arrester, interface box, and mounting bracket

ASE-FA12 - 39' (12 meters) LMR400

- passive antenna, and mounting bracket

ASE-FA20 - 65' (20 meters) LMR600

- passive antenna, and mounting bracket

CONTACT BLUE SKY NETWORK

San Diego, CA Office

5353 Mission Center Road, #222
San Diego, CA 92108, USA

Phone: +1 858-551-3894

E-mail: sales@blueskynetwork.com

Scottsdale, AZ Office

16559 N 92nd Street, #101
Scottsdale, AZ 85260, USA

Phone: +1 480-443-1424

E-mail: sales@blueskynetwork.com



www.blueskynetwork.com

San Diego, CA: +1 858-551-3894

Scottsdale, AZ: +1 480-443-1424

sales@blueskynetwork.com