

BSN RESILIENCY



RESILIENCY SOLUTIONS

*Voice solutions for disaster
preparedness and business
continuity*

www.blueskynetwork.com

Blue Sky Network 

PREMIER EMERGENCY VOICE AND RESILIENCY SOLUTIONS

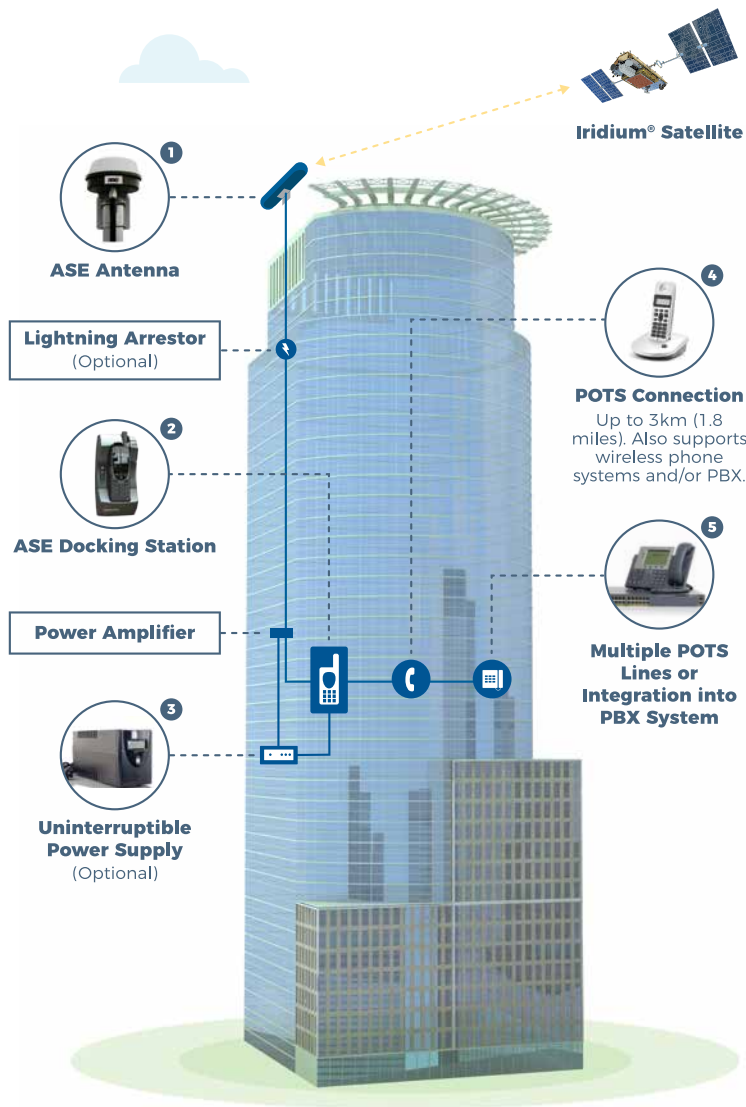

Blue Sky Network provides premier Iridium voice communication solutions for your resilience emergency preparedness and business continuity plan.

We have solutions that can be permanent satellite phone installations indoors, or installations that have removable satellite handsets (“Grab and Go”).

We meet the challenges of bringing satellite voice indoors with “right-sized” installations from single level structures to the world’s tallest buildings.

RESOURCES

Click the button below to download resources, such as data sheets, images, instructions, quick start guides, and to create a tailored solution.

CLICK HERE



RESILIENCY SYSTEM COMPONENTS

Bringing Iridium satellite communication indoors and out of the weather with a fixed installation, yet providing the ability to undock the handset when the situation requires that you “Grab and Go”. Our resiliency product line is marketed under the Applied Satellite Engineering (ASE) name.

Our resiliency packages support all Iridium handsets.

ANTENNA AND CABLE SELECTION:

- › **ASE-PFA12** 12M (39 ft), LMR600, Premium Passive Filtered Antenna Lightning Arrester
- › **ASE-PFA20** 20M (66 ft), LMR600, Premium Passive Filtered Antenna Lightning Arrester
- › **ASE-PFA27** 27M (89 ft), LMR200, Premium Active Powered Filtered Antenna Lightning Arrester
- › **ASE-PFA40** 40M (131 ft), RG213, Premium Active Powered Filtered Antenna Lightning Arrester
- › **ASE-PFA70** 70M (230 ft), LMR400, Premium Active Powered Filtered Antenna Lightning Arrester
- › **ASE-PFA88** 88M (289 ft), LMR500, Premium Active Powered Filtered Antenna Lightning Arrester
- › **ASE-PFA105** 105M (344 ft), LMR600, Premium Active Powered Filtered Antenna Lightning Arrester
- › **ASE-FA12** 12M (39 ft), LMR400, Passive Antenna
- › **ASE-FA20** 20M (65 ft), LMR600, Passive Antenna

INDOOR SATELLITE PHONE

- ASE 9555-DK050/DK075
- ASE 9575
- ASE 9505A (MC03)
- ASE MC08 - FIXED STATION

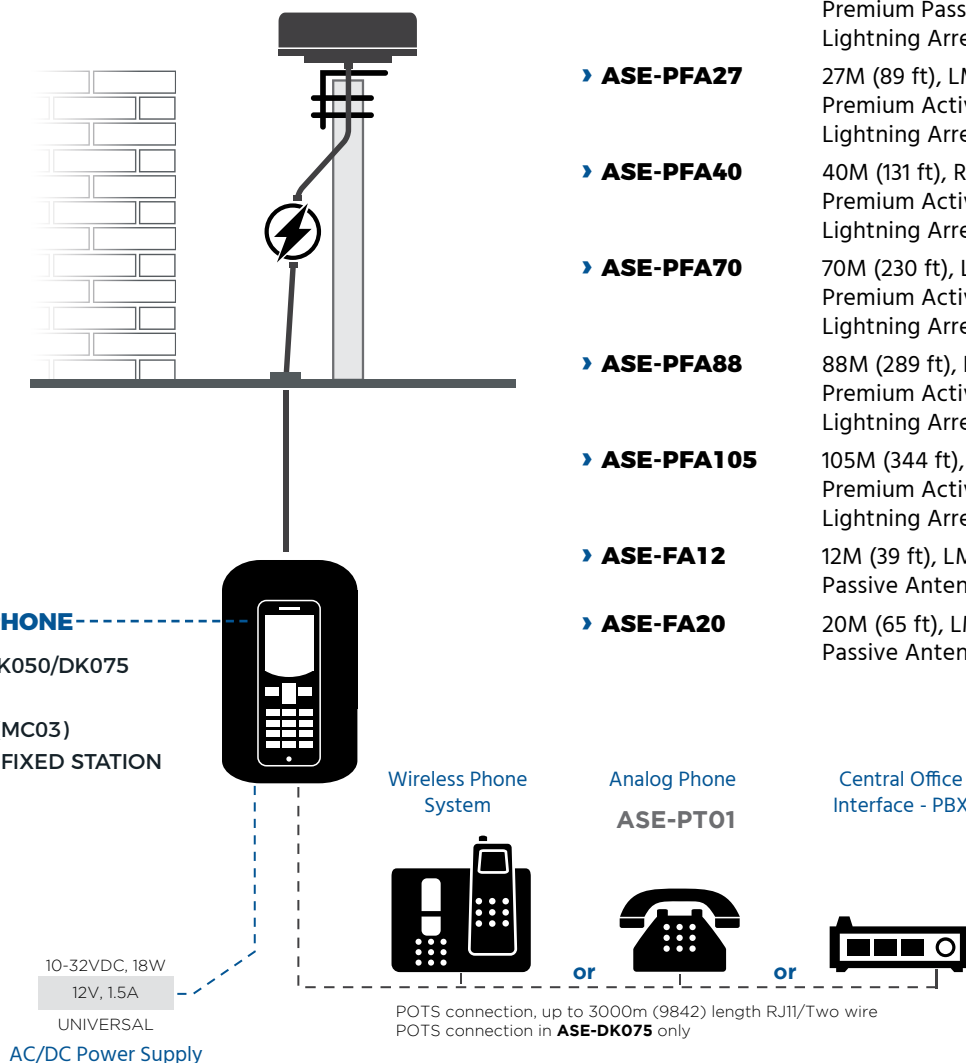

INDOOR SATELLITE PHONE OPTIONS

IRIDIUM 9555 DOCKING STATION



ASE-DK075



ASE-DK050



ASE-MNT01

IRIDIUM 9555 DOCKING STATION OPTIONS:

ASE-DK075 9555 docking station with POTS for office infrastructure integration

ASE-DK050 Docking station only

ADDITIONAL SYSTEM OPTIONS:

ASE-MNT01 Optional/additional corded handset

9555 DOCKING STATION RESOURCES:

Click on the button to the right to access product resources and files such as the user guide, installation guide, troubleshooter, drawings, images and more.

CLICK HERE



IRIDIUM 9575 DOCKING STATION



ASE-9575P-HQ



ASE-MNT03



PALM SPEAKER/MIC

IRIDIUM 9575 DOCKING STATION OPTIONS:

ASE-9575P-HQ 9575 docking station with POTS for office infrastructure integration

ADDITIONAL SYSTEM OPTIONS:

ASE-9575P-HQ-H Corded Handset

ASE-9575P-HQ-P Palm speaker/mic

9575 DOCKING STATION RESOURCES:

Click on the button to the right to access product resources and files such as the user guide, installation guide, troubleshooter, drawings, images and more.

CLICK HERE



INDOOR SATELLITE PHONE OPTIONS

FIXED SITE TERMINAL SOLUTIONS

Sometimes it is most important to make sure all the components for the emergency system remains completely in place. A fixed site installation using a built-in transceiver provides always available indoor satellite communication.



ASE-MC08



ASE-MC08-H

COMCENTER II INDOOR OPTIONS:

ASE-MC08

Fixed station Iridium voice terminal with POTS for office infrastructure integration

- › Includes ADU (MC08G), 50' (15 meter) cable (12050T), breakout plastic wall plate (12000T), and mounting bracket (MNT20).

ASE-MC08-H

Fixed station Iridium voice terminal with POTS for office infrastructure integration and privacy handset

- › Includes ADU (MC08G), privacy handset (ASE-MNT07), 50' (15 meter) cable (12050T), breakout plastic wall plate (12000T), and mounting bracket (MNT20).

MC08 RESOURCES:

Click on the button to the right to access product resources and files such as the user guide, installation guide, trouble-shooter, drawings, images and more.

CLICK HERE



ANTENNA AND CABLE OPTIONS

CABLE LENGTHS AND ANTENNA OPTIONS



ACTIVE POWERED

- › **ASE-PFA12** 12M (39 ft), LMR600, Premium Passive Filtered Antenna Lightning Arrester
 - › **ASE-PFA20** 20M (66 ft), LMR600, Premium Passive Filtered Antenna Lightning Arrester
 - › **ASE-PFA27** 27M (89 ft), LMR200, Premium Active Powered Filtered Antenna Lightning Arrester
 - › **ASE-PFA40** 40M (131 ft), RG213, Premium Active Powered Filtered Antenna Lightning Arrester
 - › **ASE-PFA70** 70M (230 ft), LMR400, Premium Active Powered Filtered Antenna Lightning Arrester
 - › **ASE-PFA88** 88M (289 ft), LMR500, Premium Active Powered Filtered Antenna Lightning Arrester
 - › **ASE-PFA105** 105M (344 ft), LMR600, Premium Active Powered Filtered Antenna Lightning Arrester
-
- › **ASE-FA12** 12M (39 ft), LMR400, Passive Antenna
 - › **ASE-FA20** 20M (65 ft), LMR600, Passive Antenna



PREMIUM FILTERED



PASSIVE

ANTENNA AND CABLE RESOURCES:

Click on the button to the right to access product resources and files such as installation manuals, videos, an antenna length calculator, and more.

CLICK HERE



COMCENTER II OUTDOOR SYSTEM COMPONENTS

ASE-MC05 FIXED SITE TERMINAL SOLUTION

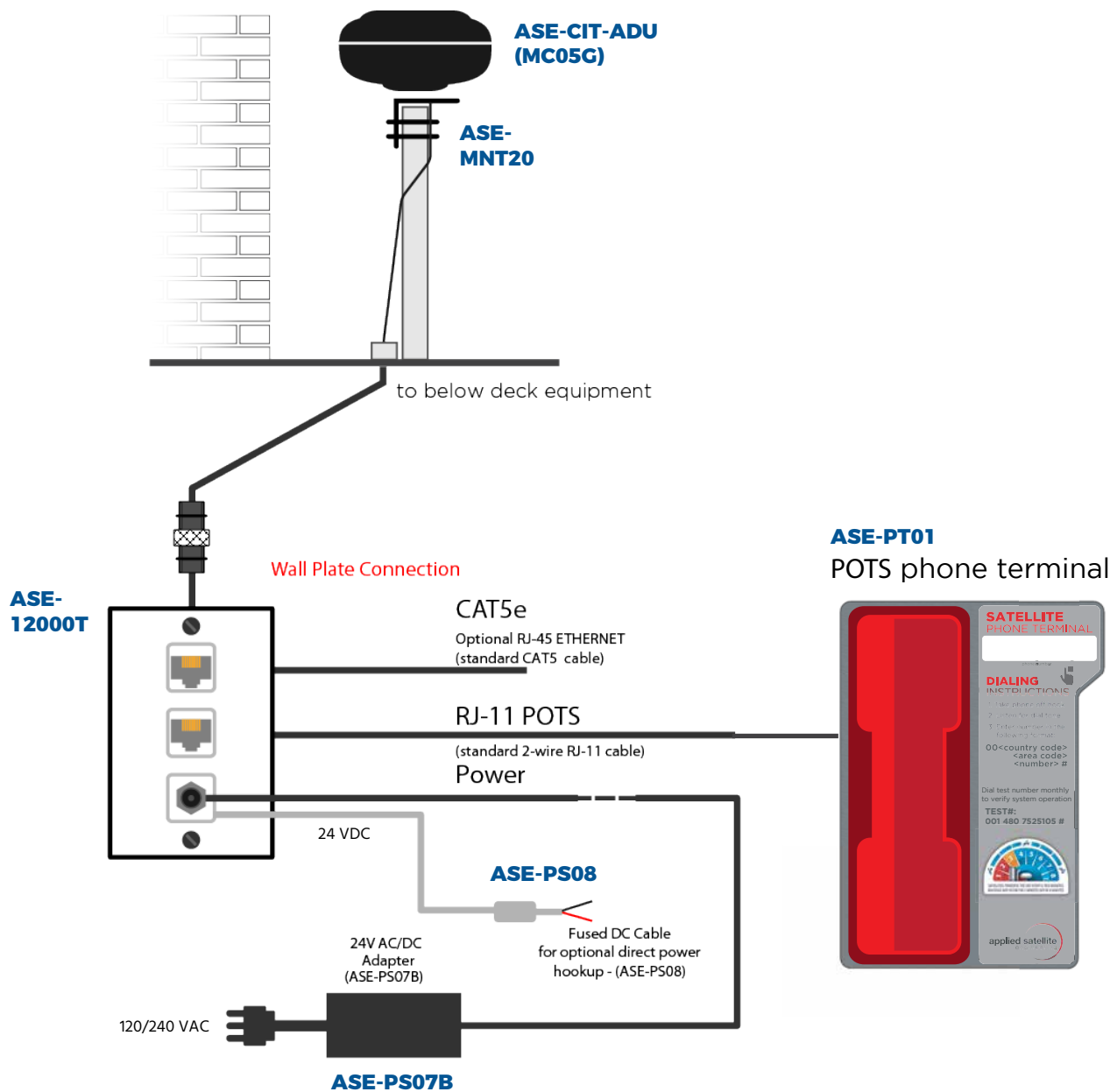

ALL-IN-ONE RESILIENCY SYSTEM OPTIONS

COMCENTER II OUTDOOR FIXED STATION TERMINAL



ASE-MC05

COMCENTER II OUTDOOR OPTIONS:

ASE-MC05

Fixed station Iridium voice terminal with POTS for office infrastructure integration

- › Includes ADU (MC05), 50' (15 meter) cable (12050T), breakout plastic wall plate (12000T), and mounting bracket (MNT20).

CABLE EXTENDER OPTIONS:

ASE-12050T

50' (15 meters)

ASE-12100T

100' (30 meters)

ASE-12150T

150' (60 meters)

ASE-12328T

328' (100 meters)

COMCENTER II OUTDOOR RESOURCES:

Click on the button to the right to access product resources and files such as installation manuals, user guides, trouble-shooters, videos, cutsheets, drawings, and more.

CLICK HERE



RESILIENCY PACKAGE COMPONENTS

SPECIFICATIONS AND SHIPPING INFORMATION

ASE-
9575P-HQ-P

Standard/Push to Talk Docking Station with POTS and GPS: Includes dock, office mount, palm speaker/mic

Harmonized Code - HTS#: 8518.30.2000 **ECCN:** EAR99

Shipping Dimensions: 16 x 14 x 8, 6 LBS (41cm x 36cm x 20cm, 3 kg)



ASE-
9575P-HQ-H

Standard/Push to Talk Docking Station with POTS and GPS: Includes dock, office mount, DPL intelligent handset

Harmonized Code - HTS#: 8518.30.2000 **ECCN:** EAR99

Shipping Dimensions: 16 x 14 x 8, 6 LBS (41cm x 36cm x 20cm, 3 kg)



ASE-
9575P-HQ

Standard/Push to Talk Docking Station with POTS and GPS: Includes dock, office mount

Harmonized Code - HTS#: 8518.30.2000 **ECCN:** EAR99

Shipping Dimensions: 16 x 14 x 8, 6 LBS (41cm x 36cm x 20cm, 3 kg)



ASE-
DK050

9555 Docking Station: Includes DK050 docking station

Harmonized Code - HTS#: 8518.30.2000 **ECCN:** EAR99

Shipping Dimensions: 16 x 14 x 8, 6 LBS (41cm x 36cm x 20cm, 3 kg)



ASE-
DK050-H

9555 Docking Station: Includes DK050 docking station, DPL intelligent handset

Harmonized Code - HTS#: 8518.30.2000 **ECCN:** EAR99

Shipping Dimensions: 16 x 14 x 8, 6 LBS (41cm x 36cm x 20cm, 3 kg)



ASE-
DK075

9555 Docking Station: Includes DK075 with POTS docking station

Harmonized Code - HTS#: 8518.30.2000 **ECCN:** EAR99

Shipping Dimensions: 16 x 14 x 8, 6 LBS (41cm x 36cm x 20cm, 3 kg)



ASE-
DK075-H

9555 Docking Station: Includes DK075 with POTS docking station, DPL intelligent handset

Harmonized Code - HTS#: 8518.30.2000 **ECCN:** EAR99

Shipping Dimensions: 16 x 14 x 8, 6 LBS (41cm x 36cm x 20cm, 3 kg)



RESILIENCY PACKAGE COMPONENTS

SPECIFICATIONS AND SHIPPING INFORMATION

ASE-MC08	ComCenter II Indoor: Fixed station iridium voice terminal	
	Harmonized Code - HTS#: 8517.62.0050 ECCN: 5A992.a Shipping Dimensions: 16 x 14 x 8, 6 LBS (41cm x 36cm x 20cm, 3 kg)	
ASE-MC08-H	ComCenter II Indoor: Fixed station iridium voice terminal	
	Harmonized Code - HTS#: 8517.62.0050 ECCN: 5A992.a Shipping Dimensions: 16 x 14 x 8, 6 LBS (41cm x 36cm x 20cm, 3 kg)	
ASE-PT01	POTS Station: Includes POTS phone, mount plate, and instruction placard	
	Harmonized Code - HTS#: 8518.30.2000 ECCN: EAR99 Shipping Dimensions: 16 x 14 x 8, 5 LBS (41cm x 36cm x 20cm, 2 kg)	
ASE-PFA12	Premium Filtered Passive Antenna kit: 39' (12 meters) LMR600 cable, premium passive filtered antenna, lightning arrester, and mounting bracket	
	Harmonized Code - HTS#: 8517.70.0000 ECCN: EAR99 Shipping Dimensions: 16 x 14 x 8, 6 LBS (41cm x 36cm x 20cm, 3 kg)	
ASE-PFA20	Premium Filtered Passive Antenna kit: 66' (20 meters) LMR600 cable, premium passive filtered antenna, lightning arrester, and mounting bracket	
	Harmonized Code - HTS#: 8517.70.0000 ECCN: EAR99 Shipping Dimensions: 16 x 14 x 8, 12 LBS (41cm x 36cm x 20cm, 5 kg)	
ASE-PFA27	Premium Filtered Active Antenna kit: 89' (27 meters) LMR200 cable, premium passive filtered antenna, lightning arrester, interface box, and mounting bracket	
	Harmonized Code - HTS#: 8517.70.0000 ECCN: EAR99 Shipping Dimensions: 16 x 14 x 8, 18 LBS (41cm x 36cm x 20cm, 8 kg)	
ASE-PFA40	Premium Filtered Active Antenna kit: 131' (40 meters) RG213 cable, premium passive filtered antenna, lightning arrester, interface box, and mounting bracket	
	Harmonized Code - HTS#: 8517.70.0000 ECCN: EAR99 Shipping Dimensions: 20 x 16 x 14, 24LBS (41cm x 36cm x 20cm, 11 kg)	

RESILIENCY PACKAGE COMPONENTS

SPECIFICATIONS AND SHIPPING INFORMATION

ASE-PFA70	<p>Premium Filtered Active Antenna kit: 230' (70 meters) LMR400 cable, premium passive filtered antenna, lightning arrester, interface box, and mounting bracket</p> <p>Harmonized Code - HTS#: 8517.70.0000 ECCN: EAR99</p> <p>Shipping Dimensions: 20 x 16 x 14, 32 LBS (41cm x 36cm x 20cm, 15 kg)</p>	A photograph of the Premium Filtered Active Antenna kit for 230 feet, showing the antenna, cable, and mounting hardware.
ASE-PFA88	<p>Premium Filtered Active Antenna kit: 289' (88 meters) LMR500 cable, premium passive filtered antenna, lightning arrester, interface box, and mounting bracket</p> <p>Harmonized Code - HTS#: 8517.70.0000 ECCN: EAR99</p> <p>Shipping Dimensions: 20 x 16 x 14, 38 LBS (41cm x 36cm x 20cm, 17 kg)</p>	A photograph of the Premium Filtered Active Antenna kit for 289 feet, showing the antenna, cable, and mounting hardware.
ASE-PFA105	<p>Premium Filtered Active Antenna kit: 344' (105 meters) LMR600 cable, premium passive filtered antenna, lightning arrester, interface box, and mounting bracket</p> <p>Harmonized Code - HTS#: 8517.70.0000 ECCN: EAR99</p> <p>Shipping Dimensions: 20 x 16 x 14, 42 LBS (41cm x 36cm x 20cm, 19 kg)</p>	A photograph of the Premium Filtered Active Antenna kit for 344 feet, showing the antenna, cable, and mounting hardware.
ASE-FA12	<p>Passive Antenna kit: 40 ft (12 m) LMR400 cable, passive antenna, and mount</p> <p>Harmonized Code - HTS#: 8517.70.0000 ECCN: EAR99</p> <p>Shipping Dimensions: 16 x 14 x 8, 6 LBS (41cm x 36cm x 20cm, 3 kg)</p>	A photograph of the Passive Antenna kit for 40 feet, showing the antenna, cable, and mounting hardware.
ASE-FA20	<p>Passive Antenna kit: 66 ft (20 m) LMR600 cable, passive antenna, and mount</p> <p>Harmonized Code - HTS#: 8517.70.0000 ECCN: EAR99</p> <p>Shipping Dimensions: 16 x 14 x 8, 12 LBS (41cm x 36cm x 20cm, 5 kg)</p>	A photograph of the Passive Antenna kit for 66 feet, showing the antenna, cable, and mounting hardware.
ASE-DA12	<p>DA12: 40 ft (12 m) 2 x LMR400 cable, Dual (Irid/GPS) antenna</p> <p>Harmonized Code - HTS#: 8517.70.0000 ECCN: EAR99</p> <p>Shipping Dimensions: 16 x 14 x 8, 12 LBS (41cm x 36cm x 20cm, 5 kg)</p>	A photograph of the DA12 Dual Antenna kit for 40 feet, showing the dual antenna, cable, and mounting hardware.
ASE-DA20	<p>DA20: 66 ft (20 m) 2 x LMR600 cable, Dual (Irid/GPS) antenna</p> <p>Harmonized Code - HTS#: 8517.70.0000 ECCN: EAR99</p> <p>Shipping Dimensions: 20 x 16 x 14, 20 LBS (51cm x 41cm x 36cm, 9 kg)</p>	A photograph of the DA20 Dual Antenna kit for 66 feet, showing the dual antenna, cable, and mounting hardware.

RESILIENCY PACKAGE COMPONENTS

SPECIFICATIONS AND SHIPPING INFORMATION

ASE-DA40	DA40: 131 ft (40 m) 2 x RG214 cable, active antenna, and GPS antenna	
	Harmonized Code - HTS#: 8517.70.0000 ECCN: EAR99 Shipping Dimensions: 20 x 16 x 14, 20 LBS (51cm x 41cm x 36cm, 14 kg)	
ASE-DA70	DA70: 230 ft (70 m) 2 x LMR400 cable, active antenna, and GPS antenna	
	Harmonized Code - HTS#: 8517.70.0000 ECCN: EAR99 Shipping Dimensions: 22 x 18 x 16, 52 LBS (56cm x 46cm x 41cm, 24 kg)	
ASE-LA01 / LA02	ASE-LA01: Lightning arrester for premium antenna kits (PFA) ASE-LA02: Lightning arrester for antenna kits (ASE-FA12 and ASE-FA20)	
	Harmonized Code - HTS#: 8517.70.0000 ECCN: EAR99 Shipping Dimensions: 8 x 8 x 8, 2 LBS (20cm x 20cm x 20cm, 1 kg)	
ASE-MNT01	Handset and Mounting kit: For 9555 Docking station family	
	Harmonized Code - HTS#: 8518.30.2000 ECCN: EAR99 Shipping Dimensions: 8 x 8 x 8, 2 LBS (20cm x 20cm x 20cm, 1 kg)	
ASE-MNT03	Handset and Mounting kit: For 9575 Docking station family	
	Harmonized Code - HTS#: 8504.40.8500 ECCN: EAR99 Shipping Dimensions: 8 x 8 x 8, 2 LBS (20cm x 20cm x 20cm, 1 kg)	
ASE-MNT04	Handset and Mounting kit: For 9505A Docking station family	
	Harmonized Code - HTS#: 8518.30.2000 ECCN: EAR99 Shipping Dimensions: 8 x 8 x 8, 2 LBS (20cm x 20cm x 20cm, 1 kg)	
ASE-MNT07	Handset and Mounting kit: For ComCenter II family	
	Harmonized Code - HTS#: 8518.30.2000 ECCN: EAR99 Shipping Dimensions: 8 x 8 x 3, 2 LBS (20cm x 20cm x 8cm, 1 kg)	

RESILIENCY PACKAGE COMPONENTS

SPECIFICATIONS AND SHIPPING INFORMATION

ASE-PS01	ASE-PS01: AC/DC converter for 9505A docking station family	
	Harmonized Code - HTS#: 8504.40.8500 ECCN: EAR99 Shipping Dimensions: 9 x 9 x 3, 2 LBS (23cm x 23cm x 8cm, 1 kg)	
ASE-PS02	ASE-PS02: DC converter with cigarette lighter adapter	
	Harmonized Code - HTS#: 8504.40.8500 ECCN: EAR99 Shipping Dimensions: 9 x 9 x 3, 2 LBS (23cm x 23cm x 8cm, 1 kg)	
ASE-PS05	ASE-PS05: AC/DC converter for 9555 and 9575 docking station families, and ComCenter II Indoor station	
	Harmonized Code - HTS#: 8504.40.8500 ECCN: EAR99 Shipping Dimensions: 9 x 9 x 3, 2 LBS (23cm x 23cm x 8cm, 1 kg)	
ASE-PS06	ASE-PS06: DC power cable with cigarette lighter adapter	
	Harmonized Code - HTS#: 8504.40.8500 ECCN: EAR99 Shipping Dimensions: 9 x 9 x 3, 2 LBS (23cm x 23cm x 8cm, 1 kg)	
ASE-PS07	ASE-PS07: AC/DC converter for ComCenter II Outdoor	
	Harmonized Code - HTS#: 8504.40.8500 ECCN: EAR99 Shipping Dimensions: 9 x 9 x 3, 2 LBS (23cm x 23cm x 8cm, 1 kg)	
ASE-PS071-2	ASE-PS071-2: AC/DC converter for AA511-2 active antenna	
	Harmonized Code - HTS#: 8504.40.8500 ECCN: EAR99 Shipping Dimensions: 9 x 9 x 3, 2 LBS (23cm x 23cm x 8cm, 1 kg)	
ASE-MC05	ComCenter II Outdoor: Fixed station iridium voice terminal (MC05) with built in antenna for exposed installation.	
	Harmonized Code - HTS#: 8517.62.0050 ECCN: 5A992.a Shipping Dimensions: 16 x 13 x 13, 10 LBS (41cm x 33cm x 33cm, 5 kg)	

RESILIENCY PACKAGE COMPONENTS

SPECIFICATIONS AND SHIPPING INFORMATION

ASE-
12000T

RJ11 and RJ45 cable adapter for the ComCenter Outdoor - cable adapter for the ComCenter Outdoor - RJ11/RJ45/Power and plastic wall plate

Harmonized Code - HTS#: 8544.20.0000 **ECCN:** EAR99

Shipping Dimensions: 8 x 8 x 3, 2 LBS (20cm x 20cm x 8cm, 1 kg)



ASE-
12050T

50' (15m) Cable for ComCenter II Outdoor - turret connection 1" (3cm) diameter

Harmonized Code - HTS#: 8544.20.0000 **ECCN:** EAR99

Shipping Dimensions: 20 x 16 x 8, 3 LBS (51cm x 41cm x 20cm, 2 kg)



ASE-
12100T

100' (30m) Cable for ComCenter II Outdoor - turret connection 1" (3cm) diameter

Harmonized Code - HTS#: 8544.20.0000 **ECCN:** EAR99

Shipping Dimensions: 20 x 16 x 8, 6 LBS (51cm x 41cm x 20cm, 3 kg)



ASE-
12150T

150' (46m) Cable for ComCenter II Outdoor - turret connection 1" (3cm) diameter

Harmonized Code - HTS#: 8544.20.0000 **ECCN:** EAR99

Shipping Dimensions: 20 x 16 x 8, 9 LBS (51cm x 41cm x 20cm, 4 kg)



ASE-
12328T

328' (100m) Cable for ComCenter II Outdoor - turret connection 1" (3cm) diameter

Harmonized Code - HTS#: 8544.20.0000 **ECCN:** EAR99

Shipping Dimensions: 20 x 16 x 8, 16 LBS (51cm x 41cm x 20cm, 7 kg)



ASE-
GSK01-CIT

Gasket Kit for ComCenter Outdoor II - annual maintenance gasket kit

Harmonized Code - HTS#: 8544.20.0000 **ECCN:** EAR99

Shipping Dimensions: 12 x 8 x 3, 2 LBS (30cm x 20cm x 8cm, 1 kg)



ASE-
MNT20

Mounting System for ComCenter Outdoor: Vibration mount bracket with horizontal or vertical mounting options

Harmonized Code - HTS#: 8544.20.0000 **ECCN:** EAR99

Shipping Dimensions: 8 x 8 x 8, 2 LBS (20cm x 20cm x 20cm, 1 kg)

